



## PV057-BST/PV057-LST/PV057-TST

HMI System

The PV series is a low budget entry device for simple applications equipped with necessary basic functions. It is a high function but cost effective HMI which can communicate with popular programmable controllers. With rugged plastic housing and IP65 front panel, the PV series conquers most harsh environments and meets many applications need, such as factory Automation, Bulding Automation, Specified tools...etc

### Features

- High Quality Control and 100% Product test
- IP65F Equivalent Front Panel with Function keys
- Built-in fanless, reliable and high function RISC 32-bits CPU.
- Provides CCFL backlight/LED backlight/Color TFT LCD
- Provided standard 128K battery backup memory for Alarm-
- Recipe Multi-Languages – Unicode & BMP – JPG – GIF graphic formats
- Support Multi-Languages Unicode & BMP JPG GIF graphic formats
- Provides accommodative Software



# PV057-BST/PV057-LST/PV057-TST



## SPECIFICATIONS

**CPU\_RISC** 32 bit CPU

### Display Type

PV057-BST/PV057-LST: monochrome STN LCD, 16 gray levels  
 PV057-TST/PV057-TNT:TFT Colors STN, 256 colors

### Backlight

PV057-BST/PV057-TST:CCFL Backlight  
 (over 50.000 operation hours under normal temperature)  
 PV057-LST:LED Backlight  
 (over 100.000 operation hours under normal temperature)

### Resolution

PV057-BST/PV057-LST:320x240(5,7" diagonal)  
 PV-TST/PV057-TNT:230x234(5,6" diagonal)

**Communication** COM1/COM2, 2 Serial Ports

**Operation** Touch Panel

**Touch Panel** Hardness/4H, 4-wire analog resistance,  
 1 million activation minimal

**Ethernet Port** Optional

**Text Range** 6x8 dot font □ 96x96 dot font/Windows Internal Font

**Input Power** DC20V □ DC28V

**Flash Memory** 1MB □ 16MB(Optional)

**System Working Memory** 1024 KB

**Battery Backup Memory** 128KB □ 1MB (Optional)

**Power Consumption** 10W

## PARTS INTRODUCTION

- ① DC24V Power Connector
- ② Ethernet Port (Optional)
- ③ Com1 (RS232/422/485) BD9\_Female
- ④ Com2 DB9\_Male Standard RS232 Serial Port
- ⑤ Com2 (422/485) 4 pin Terminal
- ⑥ DIP\_SW1-6
- ⑦ Extension Port (Ex.Optional Profibus Module)

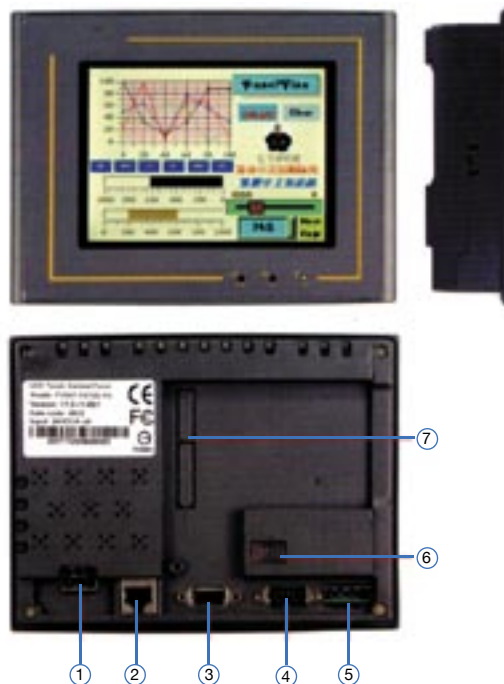

## ENVIRONMENTAL

Operative Temperature 0° □ 50°C(32° □ 120°F)  
 Relative Humidity 10% □ 90% RH; 0-50°C, non-condensing  
 Shock (Operation) 10 to 55Hz (X,Y,Z direction 2G 60 minutes)  
 EMI Complies with FCC Part 15 Class A  
 EMC Complies with EN55022, EN61000-4-2, EN61000-4-3, EN61000-4-8

Front Panel Meets NEMA4/IP65F

## CERTIFICATIONS

CE, FCC approved

## OUTLET DIMENSIONS

PV057-BST/LST/TST: 187.0 mm [7,36"]W x 143.0 mm [5,63"] H x 45.0 mm [1,77"] T

## CUTOUT DIMENSIONS

PV057-BST/LST/TST: 174.5 mm [6,88"]W x 132,5 mm [5,22"] H

## NET WEIGHT

PV057-BST/LST/TST: 0,85 Kg

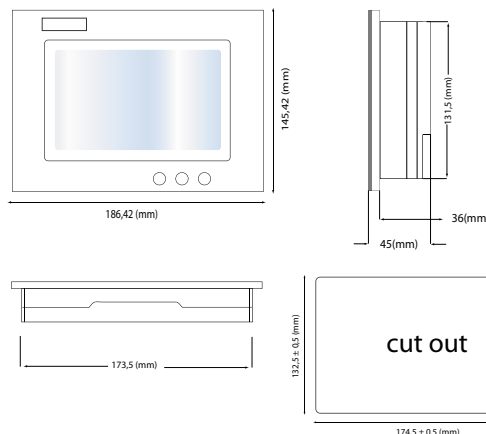

## HMI SYSTEM

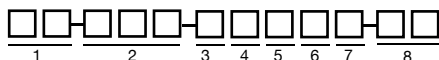

## ORDERING INFORMATION

- 1) Model: PV Series; RISC 32 Bit CPU
- 2) LCD size: 057 = 5,7 Inches
- 3) LCD Specification: B=Blue Mode Monochrome CCFL STN LCD, 16 gray levels L= Monochrome STN LCD, 16 gray levels with LED backlight T=TFT CCFL Color STN LCD, 256 colors levels
- 4) CPU I/O Specification: S=Serial Ports N=LAN Port
- 5) Operation Type: T=Touch Panel; K=Function Key
- 6) CPU Board Port Specification: 2= standard type with 2 Serial Ports
- 7) LCD Brand: K=Kyocera; N=Nanya; E=E-king; S=Sunlike
- 8) Case color: B0= black C0=black; C0=white; F0 silver black, G0=sliver white

## CMZ Sistemi Elettronici S.r.l.

Via dell'Artigianato, 21  
 31050 Vascon (TV) - Italy  
 Tel +39 0422 447411  
 Fax +39 0422 447444  
**e-mail:** cmz@cmz.it  
**web site:** www.cmz.it



# SISTEMI ELETTRONICI